

# MX.500.P022

0,2 - 2 %

5,0  
m<sup>3</sup>/h

Massima portata motore  
Maximum motor flow rate



ITA QUOTE (mm) | GB DIMENSIONS (mm)

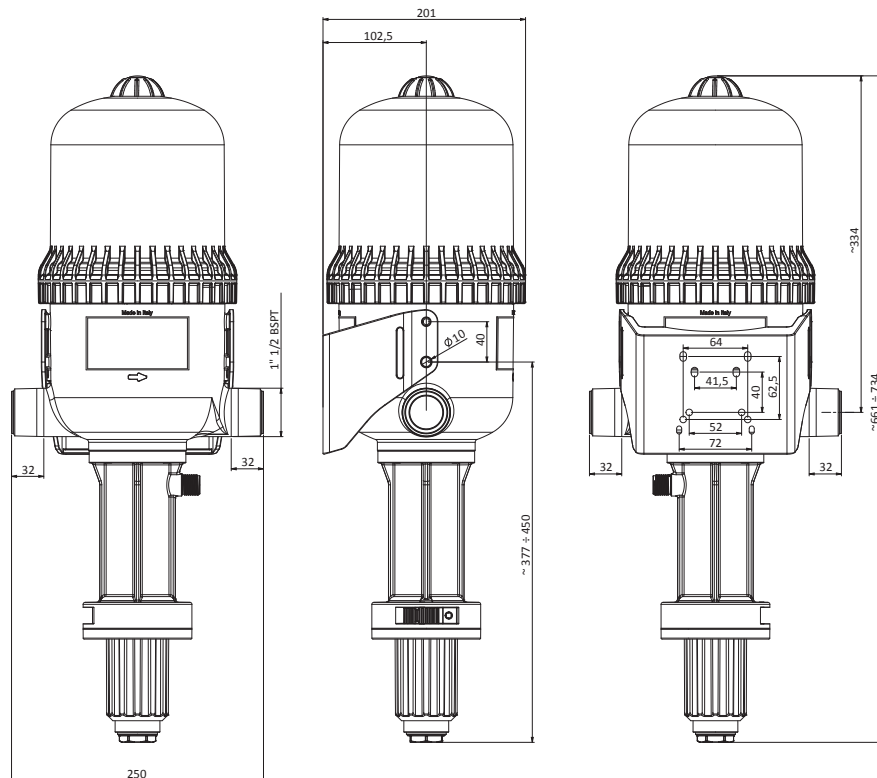

ITA CARATTERISTICHE | GB CHARACTERISTICS

Dosaggio min/max %  
Min/Max dosing ratio %

0,2 - 2 %

Min/Max rapporto dosaggio  
Min/Max dosing ratio

1:500 ; 1:50

Max portata motore  
Max water flow

5.000 l/h

Componenti plastici  
Plastic components

POM, PP, HDPE, PA12

Componenti metallici  
Metal components

AISI 316, Duplex

Guarnizioni  
Seals

Viton, EPDM

Pressione di lavoro  
Operating pressure

0,3 - 8 bar

Massima pressione statica  
Max static pressure

10 bar

Temperatura  
Temperature

5° - 40° C

ITA Grafico perdite di carico - pompa 0,2 - 2 %

GB Flow Resistance Graph - pump 0,2 - 2 %

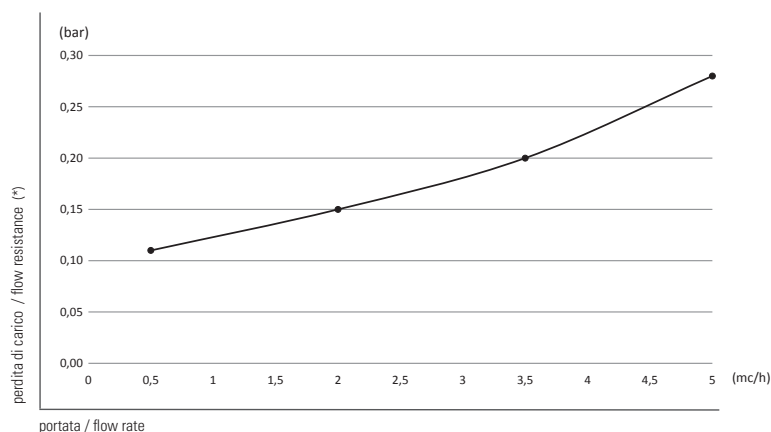

ITA VARIANTI E OPTIONAL | GB VARIANTS AND OPTIONAL

BYPASS

VERSIONE EXTREME / EXTREME VERSION

ON/OFF

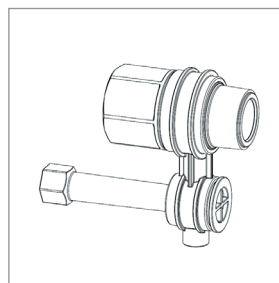

Ulteriori informazioni tecniche disponibili su richiesta  
Additional technical information available on request

**miXtron**